

campbell hausfeld impact wrench manual

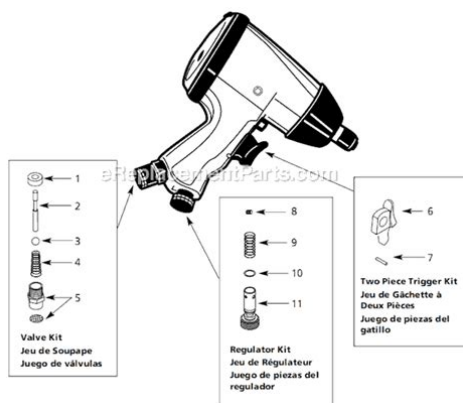

File Name: campbell hausfeld impact wrench manual.pdf

Size: 2666 KB

Type: PDF, ePub, eBook

Category: Book

Uploaded: 6 May 2019, 14:38 PM

Rating: 4.6/5 from 750 votes.

Status: AVAILABLE

Last checked: 1 Minutes ago!

In order to read or download campbell hausfeld impact wrench manual ebook, you need to create a FREE account.

[**Download Now!**](#)

eBook includes PDF, ePub and Kindle version

[Register a free 1 month Trial Account.](#)

[Download as many books as you like \(Personal use\)](#)

[Cancel the membership at any time if not satisfied.](#)

[Join Over 80000 Happy Readers](#)

Book Descriptions:

We have made it easy for you to find a PDF Ebooks without any digging. And by having access to our ebooks online or by storing it on your computer, you have convenient answers with campbell hausfeld impact wrench manual . To get started finding campbell hausfeld impact wrench manual , you are right to find our website which has a comprehensive collection of manuals listed. Our library is the biggest of these that have literally hundreds of thousands of different products represented.



Book Descriptions:

campbell hausfeld impact wrench manual

OPERATING INSTRUCTIONS IMPACT WRENCH MODELS TL1002, TL1017 AND TL1049 9. Always use attachments designed for use with air powered tools. Do not use damaged or worn attachments. Then, push the forward and reverse button in both directions. Use a torque wrench to set the torque. Models TL1002, TL1017 and TL1049 are equipped with regulators for speed adjustment See Figure 2. To remove nuts, set the regulator to the maximum setting. Freight costs, if any, must be borne by the purchaser. B. Use reasonable care in the operation and maintenance of the products as described in the owner's manuals. Why Use Air Powered Equipment Finish your automotive and woodworking projects faster and Air Tools Angle Die Grinder TL1141 Air Tools. Air Tools. Dual Action Sander PL150499. Learn more opens in a new window or tab This amount is subject to change until you make payment. For additional information, see the Global Shipping Programme terms and conditions opens in a new window or tab This amount is subject to change until you make payment. For additional information, see the Global Shipping Programme terms and conditions opens in a new window or tab This amount is subject to change until you make payment. If you reside in an EU member state besides UK, import VAT on this purchase is not recoverable. For additional information, see the Global Shipping Programme terms and conditions opens in a new window or tab Delivery times may vary, especially during peak periods and will depend on when your payment clears opens in a new window or tab. Learn More opens in a new window or tab Learn More opens in a new window or tab Learn More opens in a new window or tab Learn More opens in a new window or tab Learn More opens in a new window or tab Contact the seller opens in a new window or tab and request a postage method to your location. Please enter a valid postcode. Please enter a number less than or equal to

1. http://www.bkmm.it/upload_immagini/canon-speedlite-manual-mode.xml

- **campbell hausfeld impact wrench manual, campbell hausfeld impact wrench tl1402 manual, campbell hausfeld impact wrench tl1002 manual, campbell hausfeld air grease gun manual, 1.0.**

Sellers may be required to accept returns for items that are not as described. Learn more about your rights as a buyer. opens in a new window or tab You're covered by the eBay Money Back Guarantee if you receive an item that is not as described in the listing. All Rights Reserved. User Agreement, Privacy, Cookies and AdChoice Norton Secured powered by Verisign. Using the online preview, you can quickly view the contents and go to the page where you will find the solution to your problem with Campbell Hausfeld TL1002. To start viewing the user manual Campbell Hausfeld TL1002 on full screen, use the button Fullscreen. However, if you do not want to take up too much of your disk space, you can always download it in the future from ManualsBase. The option to print the manual has also been provided, and you can use it by clicking the link above Print the manual. You do not have to print the entire manual Campbell Hausfeld TL1002 but the selected pages only. paper. If you want to quickly view the content of pages found on the following pages of the manual, you can use them. Figure 2 Air Hose Hookup SPEED ADJUSTMENT. WARNING ! The If Campbell Hausfeld oil is not used, lubricate the tool after cleaning. 2. No oil in tool. 2. Lubricate the tool according to the lubrication instructions in this manual. 3. Low air pressure. 3.a. Read carefully before attempting to assemble, install, operate or maintain the product described. Protect yourself and others by observing all safety information. Retain instructions for future reference. Attach it to this manual or file it for safekeeping. Impact wrenches have different impact mechanism types such as rocking dog, pin clutch and twin hammer double jumbo. The rocking dog and pin clutch types

are used as general purpose tools by DIY'ers and hobbyists. Twin hammer wrenches are for use by the professional in tire shops, assembly line applications and for removing high torque bolts. <http://www.esse3-medical.com/userfiles/canon-speedlite-580ex-user-manual-download.xml>

Unpacking When unpacking this product, carefully inspect for any damage that may have occurred during transit. Make sure any loose fittings, bolts, etc., are tightened before putting this product into service. This information is 1. Read all manuals included with this product carefully. Be thoroughly familiar with the controls and the proper use of the equipment. 2. Only persons well acquainted with these rules of safe operation should be allowed to use the air tool. Do not exceed maximum operating pressure of the air tool 90 PSI. The air tool could explode and result in death or serious personal injury. 3. Do not exceed any pressure rating of any component in the system. 4. Disconnect the air tool from air supply before changing tools or attachments, servicing and during nonoperation. Safety glasses and ear protection must be worn during operation. 5. Do not wear loose fitting clothing, scarves, or neck ties. Loose clothing may become caught in moving parts and result in serious personal injury. 6. Do not wear jewelry when operating any tool. Jewelry may become caught in moving parts and result in serious personal injury. 7. Do not depress trigger when connecting the air supply hose. 8. Always use attachments designed for use with air powered tools. Do not use damaged or worn attachments. Do not use hand tool sockets. Use impact quality sockets only. Hand tool sockets are "glasshard" and will shatter and can cause serious personal injury if used with air tools. Danger indicates an imminently hazardous situation which, if not avoided, WILL result in death or serious injury. Warning indicates a potentially hazardous situation which, if not avoided, COULD result in death or serious injury. Caution indicates a potentially hazardous situation which, if not avoided, MAY result in minor or moderate injury.

Notice indicates important information, that if not followed, may cause damage to equipment. NOTE Information that requires special attention General Safety Information CALIFORNIA PROPOSITION 65 You can create dust when you cut, sand, drill or grind materials such as wood, paint, metal, concrete, cement, or other masonry. This dust often contains chemicals known to cause cancer, birth defects, or other reproductive harm. Wear protective gear. GENERAL SAFETY This product is a part of a high pressure system and the following safety precautions must be followed at all times along with any other existing safety rules. MANUAL 1 2 3. 16 Summary of content 16 pages Page 1 See Warranty on page 4 for important information about commercial use of this product. Operating Instructions Please read and save these instructions. Read carefully before attempting to assemble, install, operate or maintain the product described. Protect yourself and others by observing all safety information. Retain instructions for future reference. Impact Wrenches Table of Contents Description..... Page 2 Impact Wrenches General Safety Information Continued 9. Never trigger the tool when not applied to a work object. Attachments must be securely attached. Loose attachments can cause serious injury. 10. Protect air lines from damage or puncture. 11. Never point an air tool at oneself or any other person. Serious injury could occur. 12. Check air hoses for weak or worn condition before each use. Make sure all connections are secure. Page 3 Storage Technical Service The impact wrench must be lubricated before storing. Follow the air motor lubrication instructions with an exception to step 4. Only run the impact wrench for 2 to 3 seconds instead of 20 to 30 seconds because more oil needs to remain in the impact wrench when storing. For information regarding the operation or repair of this product, please call 18005436400.

Instructions D'Utilisation S'il vous plait lire et conserver ces instructions. Lire attentivement avant de monter, installer, utiliser ou de procéder à l'entretien du produit décrit. Conserver ces instructions comme référence. Page 6 Clés à Chocs Généralités sur la Sécurité Suite 5. Ne pas porter de vêtements flottants, d'écharpe ni de cravate. Les vêtements flottants risquent de se prendre dans les pièces mobiles, ce qui peut provoquer des blessures graves. 6. Ne pas porter de

bijoux lorsqu'on utilise un outil quelconque. Ils risquent de se prendre dans les pièces mobiles, ce qui peut provoquer des blessures graves. 7. Ne pas appuyer sur la gachette lorsque l'on branche le tuyau d'alimentation en air. 8. Page 7 Fonctionnement Suite 6. Si l'huile est sale, recommencer l'opération précédente jusqu'à ce que l'huile qui s'écoule soit claire. Poser la vis et la serrer. L'huile qui reste dans la chambre du mécanisme de choc est suffisante pour assurer un graissage correct. REGLAGE DE LA VITESSE La cle à chocs ne doit jamais être utilisée pour serrer au couple. Utiliser une cle dynamométrique pour serrer au couple. Page 8 Cles à Chocs Guide Général De Dépannage Symptôme Causes Possibles L'outil tourne trop lentement ou ne fonctionne pas 1. Présence de grenaille ou de gomme 1. Rincer l'outil avec de l'huile pour outil pneumatique Campbell dans l'outil Hausfeld, du dissolvant de gomme ou un mélange en proportions égales d'huile de moteur SAE 10 et de kérosène. Instrucciones de Funcionamiento Sirvase leer y guardar estas instrucciones. Lea con cuidado antes de tratar de armar, instalar, manejar o darle servicio al producto descrito en este manual. Protejase Ud. y a los demás observando todas las reglas de seguridad. Guarde este manual como referencia. Page 12 Pistola de Impacto Informaciones Generales de Seguridad Continuación 6. Quitese las joyas para operar cualquier herramienta. Las joyas se le pueden enredar en la herramienta y ocasionarle heridas graves. 7.

No oprima el gatillo mientras este conectando la manguera de la fuente de aire. 8. Siempre use accesorios diseñados para usarse con herramientas neumáticas. No use accesorios dañados o deteriorados. No use dados para herramientas manuales. Solo use dados para llaves de impacto. Page 13 Fonctionnement Continuación Para sacar tuercas de llantas de automóviles o pernos, coloque el regular en lo máximo. Para colocarlos, siempre use un torquímetro para apretarlos adecuadamente. Not intended for assembly line Make sure to tighten fittings, bolts, etc., before putting unit into service. Wash hands after handling. This dust often contains chemicals known to cause cancer, birth defects, or other reproductive harm. Wear protective gear. This information is provided for SAFETY and to PREVENT EQUIPMENT PROBLEMS. To help recognize this information, observe the following symbols. Contact your Campbell Hausfeld representative if you have any questions. Read carefully before attempting to assemble, install, operate or maintain the product described. Protect yourself and others by observing all safety information. Retain instructions for future reference. Our payment security system encrypts your information during transmission. We don't share your credit card details with thirdparty sellers, and we don't sell your information to others. Please try again. Please try again. The Air Power Expert. Show details Register a free business account Please try your search again later. The company's history of creating quality products began in 1836, when it manufactured horsedrawn wagons and agricultural equipment. Today, the company offers a complete line of air compressors, air tools and accessories, inflators, nailers and staplers, paint sprayers, pressure washers, and more. Finish your projects faster and easier with Campbell Hausfeld The Air Power Expert.

These distinctive tools help you Get Stuff Done because we reduced their weight and made them more comfortable to operate, so you can use them in more places and work longer before needing a break. You'll also get robust, adjustable power output and rugged durability — the things you need to Get Stuff Done. Rubberized, ergonomic comfortgrip with an easypull trigger makes this unit user friendly. The composite housing reduces tool weight 5.6 lbs. while maintaining durability; combined with the rubberized comfort grip the XT002000 features a user friendly design. With a maximum torque 750 ft. Lbs., BPM of 1,200 and RPM of 8,500, this impact wrench gets stuff done efficiently. Air inlet size of inch NPT F. an air compressor with a tank capacity of 8 gallons or larger is recommended. Get stuff done faster and easier with Campbell Hausfeld. Click here to make a request to customer service. To calculate the overall star rating and percentage breakdown by star, we don't use a simple average. Instead, our system considers things like how recent a review is and if the reviewer bought the item on Amazon. It also analyzes reviews to verify trustworthiness. Please try again later. Hoopy Frood 5.0 out of 5 stars On my first use this thing blew my mind. I love the thing

dearly and have put it through things it should never have been put through in two hard years of use. It has never complained, but it only puts out 100 ft lbs of torque. I have been limited by this enough times that I was looking for a better option. This has happened enough times that I thought I should upgrade my own equipment. Who cares if it worked well. It should at least be able to torque out more than 100 ft lbs, which is all I needed anyway. So I read all the negative reviews and they sounded like there may be legitimate concerns on quality with this CH driver but if one tests it right away one can return a defective product. So I bought it. Right after I got it I put it to work on my postandbeam chicken run.

I got that DeWalt plugin driver to finish things off, but I left nine lags not as torqued down as they could be. Now that I had a new driver, why not test it out on them. I was a little surprised at the stringent requirements for both lubrication and air supply as I read the manual Ive never had a pneumatic impact driver before. The manual is all of three pages long and almost all of the troubleshooting fills most of one page goes back to lubrication and air supply. I couldnt help but wonder how many of those negative reviewers did or didnt do their duediligence in these areas. LUBRICATION Oil the air motor before and after each use. But thats whats called for. Then drain any excess, recap and youre good to go. But I probably added 80100 drops. Nothing has come out yet. Maybe Ill just keep adding each time I use it until some does come out. FIRST USE I charged up my 17 gallon compressor at 150 psi, regulator set to 90 and wheeled it off unplugged, no electricity to the chicken run. I figured Id just run the tank out. These lags were all driven by the Ryobi so I know they were stopped at the 100 ft lb torque mark. The CH driver effortlessly continued the job. It ran slower than Id expect a 550 ftlb rated driver to go BUT. I have already mentioned I was running against manufacturer recommendations with my small quick disconnect and possibly the air hose ID. CONCLUSION Still with the ease it torqued the lags down. Having used a 350 ft lb DeWalt electric on the same type of lag connection Id estimate the CH is operating between 200 and 300 ft lbs. If I want more torque I can buy upgraded hoses and connections. But frankly all I wanted was MORE than 100 ft lbs. Additionally when I was done with that job the primary side of my regulator was at 120 psi. This strikes me as a very efficient pneumatic tool. Its far smaller and lighter than the DeWalt plugin. I will be using this on every heavy duty application I have. Ill update the review as experience dictates.

UPDATE I used this to take off ancient, rusted bolts off an exhaust system that failed on me. I used plenty of PB Blaster and my trusty Ryobi impact driver to try to break the O2 sensor nuts off. No dice. So I got this CH out again and put it to work. When the nuts broke free I though I was again impressed with its performance. Imagine my surprise when I found the nuts and NOT broken free. The CH driver simply sheared the O2 sensor mounting studs off the exhaust pipe with the nuts still attached. Id say it has more than adequate performance!They should put this critical piece of info HERE on this page so we can make an informed decision. I thought I could use it because I have enough CFM at 90 psi but I dont have enough volume to make it work the way it should. The pics of compressors on this page implies that any of these are usable with this gun but they are not according to the box it came it. This is very misleading IMO. A lot of these questions about power and speed are due to this missing piece of information. You may be able to remove a lug nut but will have to wait awhile for more air to continue if your tank is too small. Now I will have to decide either to return it or keep it for possible use at a later time with another compressor.Enough power and not super loud. However, while I was taking an engine shield off, this gun made a loud noise and cracked. They were only 10mm bolts. It cut my hand.My current car only requires 80ftlbs for the lug nuts, but I dont think this impact and my compressor would have a problem with the 100ftlbs that most domestic passenger cars require. If you have a full sized truck that requires 135150ft lbs, I would suspect you will need a compressor larger than mine to get enough torque.I used the unit for 3 solid days performing multiple jobs. It removes lug nuts with ease and had plenty of power to spare. Make sure you have the proper fittings as none are included.

You have two basic options either industrial or automotive fittings. Automotive fittings are larger and allow more air flow meaning more power. It is important to note that the tool is designed to work at 90 PSI working power. That doesn't mean set your PSI to 90 and go to work, what you'll want to do is set the tool PSI setting to 90 then squeeze the trigger and see what the actual working PSI is what the gauge reads when the tool is in use. You'll want to adjust that settings so that you are at 90 PSI when the tool is in use. That will ensure you get the desired results and performance of the tool. I believe with the proper maintenance this tool will last for several years. Very well made and easy to use. I highly recommend. The air inlet quick connect is not included with the tool, so you will need that to connect the tool to your air compressor. Sorry, we failed to record your vote. Please try again I got this one on sale, and like how it compared to CDN tire, princess auto, and home depot. Wasnt looking for anything for professional use. Cant beat the price. Sorry, we failed to record your vote. Please try again It removed the wheel nuts with ease. The different speed settings allows for the lug nuts to be tightened in stages, the lowest setting to first gently snug the lug nuts, the middle setting to firm them up and for final tightening I switch to my torque wrench. This wrench replaces a Husky impact wrench that was useless. Sorry, we failed to record your vote. Please try again Sorry, we failed to record your vote. Please try again Sorry, we failed to record your vote. Please try again Time will tell how long it lasts but I can buy many of these for the price of the Mac. Sorry, we failed to record your vote. Please try again Sorry, we failed to record your vote. Please try again Good for light things like wheels maybe. Sorry, we failed to record your vote. Please try again But impact was cheap to buy and stronger than my electric one.

Sorry, we failed to record your vote. Please try again Me semble quand meme a recommander. Sorry, we failed to record your vote. Please try again I use it as a professional mechanic and so far held 5 months with heavy use. I can buy 8 of these for one snap on gun. Sorry, we failed to record your vote. Please try again Sorry, we failed to record your vote. Please try again Has three forward speeds, so you dont have to worry about over tightening. Works awesome. Sorry, we failed to record your vote. Please try again Sorry, we failed to record your vote. Please try again Going back to my reliable mastercraft. Sorry, we failed to record your vote. Please try again In order to navigate out of this carousel please use your heading shortcut key to navigate to the next or previous heading.